

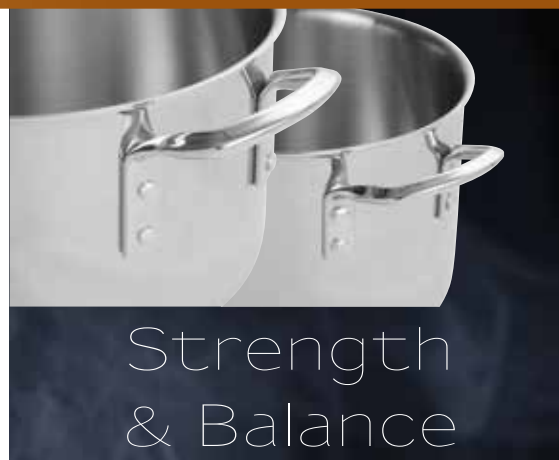

TRI-PLY INDUCTION-READY STOCK POTS

- ◆ Larger sizes for higher volume food preparation
- ◆ Securely riveted wide loop handles provide excellent stability, and roomy for handling with hot pads
- ◆ Mirror finish exterior; satin finish interior
- ◆ 6 sizes available

ITEM	DESCRIPTION	SIZE	DIA	UOM	CASE
TGSP-4	Stock Pot w/Cover	4.5 Qt	8.5"	Set	1/6
TGSP-6	Stock Pot w/Cover	6 Qt	8.5"	Set	1/6
TGSP-8	Stock Pot w/Cover	8 Qt	9.5"	Set	1/6
TGSP-12	Stock Pot w/Cover	12 Qt	12"	Set	1/4
TGSP-16	Stock Pot w/Cover	16 Qt	12.5"	Set	1/4
TGSP-20	Stock Pot w/Cover	20 Qt	14"	Set	1/4



12qt



TGSP-12

16-1/2"W including handles
7-1/4"H pot only

4.5qt



TGSP-4

13"W including handles
5-1/4"H pot only

16qt



TGSP-16

17-1/4"W including handles
8-1/4"H pot only

6qt



TGSP-6

13"W including handles
6-5/8"H pot only

20qt



TGSP-20

19"W including handles
8-1/4"H pot only

8qt



TGSP-8

13-3/4"W including handles
7-3/8"H pot only

TGSP-SERIES





SST-32



SSLB-25



SSSP-10



SSSP-6



SSLB-15



Riveted handles

PREMIUM STAINLESS STEEL COOKWARE

- ◆ Commercial-quality 18/8 stainless steel offers excellent corrosion resistance and a bright finish
- ◆ Tri-ply heavy-duty bottom for even heat distribution
- ◆ Extra-sturdy riveted handles
- ◆ Induction ready



PREMIUM STAINLESS
STEEL COOKWARE



STOCK POTS WITH COVER INCLUDED

ITEM	DESCRIPTION	SIZE (DIA X HEIGHT)	UOM	CASE
SST-8	8 Qt	9-1/2" x 6-3/4"	Set	1/4
SST-12	12 Qt	11" x 7-1/8"	Set	1/4
SST-16	16 Qt	11" x 9-3/4"	Set	1/4
SST-20	20 Qt	11-3/4" x 10-1/4"	Set	1/4
SST-24	24 Qt	13-3/8" x 10-1/4"	Set	1/2
SST-32	32 Qt	14-1/4" x 11-3/4"	Set	1/2
SST-40	40 Qt	15-3/4" x 11-3/4"	Set	1/2
SST-60	60 Qt	17-3/4" x 14-1/4"	Set	1
SST-80	80 Qt	19-3/4" x 15-3/4"	Set	1

REPLACEMENT COVERS

ITEM	UOM	CASE
SSTC-8	Each	6/12
SSTC-12	Each	6/12
SSTC-12	Each	6/12
SSTC-20	Each	6/12
SSTC-24	Each	6
SSTC-32	Each	6
SSTC-40	Each	6
SSTC-60	Each	6
SSTC-80	Each	6

SAUCE PANS WITH COVER INCLUDED

ITEM	DESCRIPTION	SIZE (DIA X HEIGHT)	UOM	CASE
SSSP-2	2 Qt	6-3/8" x 3-3/4"	Set	1/6
SSSP-3	3-1/2 Qt	8" x 4-1/4"	Set	1/6
SSSP-4	4-1/2 Qt	8" x 5-1/2"	Set	1/6
SSSP-6	6 Qt	9-1/2" x 5"	Set	1/6
SSSP-7	7-1/2 Qt w/Hdl	9-1/2" x 6-1/8"	Set	1/2
SSSP-10	10 Qt w/Hdl	11" x 6-1/8"	Set	1/2

REPLACEMENT COVERS

ITEM	UOM	CASE
SSTC-2	Each	6
SSTC-8F	Each	6/12
SSTC-8F	Each	6/12
SSTC-8	Each	6/12
SSTC-8	Each	6/12
SSTC-12	Each	6/12

BRAZILERS WITH COVER INCLUDED

ITEM	DESCRIPTION	SIZE (DIA X HEIGHT)	UOM	CASE
SSLB-8	8 Qt	11" x 5-1/8"	Set	1/4
SSLB-10	10 Qt	11-11/16" x 5-1/2"	Set	1/4
SSLB-15	15 Qt	14-1/4" x 5-1/2"	Set	1/4
SSLB-20	20 Qt	15-3/4" x 6"	Set	1/4
SSLB-25	25 Qt	17-3/4" x 6"	Set	1/2
SSLB-30	30 Qt	19-3/4" x 6"	Set	1/2

REPLACEMENT COVERS

ITEM	UOM	CASE
SSTC-12	Each	6/12
SSTC-20	Each	6/12
SSTC-32	Each	6
SSTC-40	Each	6
SSTC-60	Each	6
SSTC-80	Each	6

SAUTÉ PANS WITH COVER INCLUDED

ITEM	DESCRIPTION	SIZE (DIA X HEIGHT)	UOM	CASE
SSET-3	3 Qt	10" x 2-3/4"	Set	1/6
SSET-5	5 Qt	12-3/8" x 3-1/8"	Set	1/4
SSET-7	7 Qt	14" x 3-1/2"	Set	1/4

REPLACEMENT COVERS

ITEM	UOM	CASE
SSTC-8	Each	6/12
SSTC-20	Each	6/12
SSTC-24	Each	6



STAINLESS STEEL DOUBLE BOILERS & PERF'D STEAMERS



SSDB-20



SSDB-20S



SSDB-SERIES
SSTC-SERIES



STAINLESS STEEL DOUBLE BOILERS & PERF'D STEAMERS

- ◆ 18/8 Stainless steel; tri-ply bottom
- ◆ Cover included

ITEM	DESCRIPTION	SIZE	UOM	CASE
SSDB-8	8 Qt Double Boiler	9-1/2" x 6-3/4" & 7-1/2"	Set	1/6
SSDB-12	12 Qt Double Boiler	10-1/4" x 8-1/2" & 9-3/8"	Set	1/6
SSDB-16	16 Qt Double Boiler	11" x 9-5/8" & 10-1/2"	Set	1/4
SSDB-20	20 Qt Double Boiler	11-7/8" x 10-5/8" & 11-1/2"	Set	1/4
SSDB-8S	8 Qt Steamer/Pasta Cooker	9-1/2" x 6-3/4" & 7-1/2"	Set	1/6
SSDB-12S	12 Qt Steamer/Pasta Cooker	10-1/4" x 8-1/2" & 9-3/8"	Set	1/6
SSDB-16S	16 Qt Steamer/Pasta Cooker	11" x 9-5/8" & 10-1/2"	Set	1/4
SSDB-20S	20 Qt Steamer/Pasta Cooker	11-7/8" x 10-5/8" & 11-1/2"	Set	1/4

REPLACEMENT COVERS

ITEM	DESCRIPTION	UOM	CASE
SSTC-8	Replacement Cover for 8 Qt	Each	6/12
SSTC-10	Replacement Cover for 12 Qt	Each	6
SSTC-12	Replacement Cover for 16 Qt	Each	6/12
SSTC-20	Replacement Cover for 20 Qt	Each	6/12

CARBON STEEL PANS



CSFP-11



CSFP-SERIES



CSPP-11

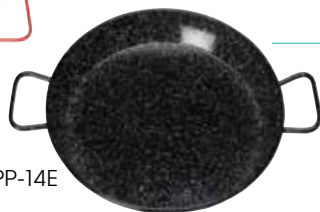

CSPP-14E



CSPP-35



POLISHED CARBON STEEL FRENCH-STYLE FRY PANS

Ideal for high-heat cooking and well suited for long pre-heating and searing.

- ◆ Made in Spain
- ◆ Sturdy, riveted handle
- ◆ **Hand wash**, dry immediately and completely; rub on light coat of cooking oil and store in dry, non-humid area

ITEM	DESCRIPTION	UOM	CASE
CSFP-7	7-7/8"	Each	5
CSFP-8	8-5/8"	Each	8
CSFP-9	9-1/2"	Each	7
CSFP-11	10-3/8"	Each	4
CSFP-12	11-1/8"	Each	3



CARBON STEEL PAELLA PANS

Create and display authentic paella dishes, roasting meat, stir-fry, and much more!

- ◆ Made in Spain
- ◆ **Hand wash**, dry thoroughly and store in dry area

ITEM	DESCRIPTION	FINISH	UOM	CASE
CSPP-7	7-7/8"	Polished	Each	12
CSPP-11	11"	Polished	Each	10
CSPP-14	14-1/8"	Polished	Each	5
CSPP-23	23-5/8"	Polished	Each	1
CSPP-35	35-1/2", 4 Hdl	Polished	Each	1
CSPP-11E	11"	Enameled	Each	10
CSPP-14E	14-1/8"	Enameled	Each	5
CSPP-23E	23-5/8"	Enameled	Each	1

INDUCTION READY ALUMINUM COOKWARE



Induction ready pot/pan base



AFPI-10H



AFPI-SERIES



NON-STICK FRY PANS



Refer to
page 64 for
induction
cooktops



AXSI-16



AXSI-SERIES



AXTI-3



COVERS FOR ALUMINUM FRY PANS



AXS-20C



AXS-SERIES

New hybrid technology bonds a stainless steel plate to aluminum cookware, as effective in utilizing induction technology as full stainless steel cookware.

- ◆ Deep drawn 3003 Aluminum body is durable and highly conductive, better than stainless steel cookware for quickly and evenly distributing heat
- ◆ Stainless steel bonded plate allows for magnetic contact with induction cooktops
- ◆ Thicker handles and heavier rivets than standard cookware allow for secure comfort in transporting cookware
- ◆ Can also be safely used with gas or electric ranges



NATURAL FINISH INDUCTION READY ALUMINUM FRY PANS

- ◆ Ergonomic comfort handle is heat resistant to 500°F (260°C)

ITEM	DESCRIPTION	PLATE SIZE	UOM	CASE
AFPI-8H*	8"Dia	5"	Each	6
AFPI-10H	10"Dia	6-1/4"	Each	6
AFPI-12H	12"Dia	6-7/8"	Each	6

*Compatible with all Winco® induction cookers.
(May not be compatible with all induction cookers on the market.)



NON-STICK INDUCTION READY ALUMINUM FRY PANS

- ◆ Quantum2® non-stick finish bonds to the aluminum for long-lasting, scratch-resistance
- ◆ Ergonomic comfort handle is heat resistant to 500°F (260°C)

ITEM	DESCRIPTION	PLATE SIZE	UOM	CASE
AFPI-8NH*	8"Dia	5"	Each	6
AFPI-10NH	10"Dia	6-1/4"	Each	6
AFPI-12NH	12"Dia	6-7/8"	Each	6

*Compatible with all Winco® induction cookers.
(May not be compatible with all induction cookers on the market.)



INDUCTION READY STOCK POTS

- ◆ Reinforced rim adds extra durability, extending the integrity of the cookware
- ◆ 3003 Aluminum, 4.0mm, 3/16" thick
- ◆ 10" diameter opening

ITEM	DESCRIPTION	HEIGHT	PLATE SIZE	UOM	CASE
AXSI-8	8 Qt	6-1/2"H	7-1/2"	Each	1
AXSI-10	10 Qt	7-1/2"H	7-1/2"	Each	1
AXSI-12	12 Qt	9"H	7-1/2"	Each	1
AXSI-16	16 Qt	12"H	7-1/2"	Each	1



INDUCTION READY SAUTÉ PAN

- ◆ Thicker handle and heavier rivets than standard cookware allow for secure comfort when lifting and carrying
- ◆ 3003 Aluminum, 4.0mm, 3/16" thick

ITEM	DESCRIPTION	PLATE SIZE	UOM	CASE
AXTI-3	3 Qt	7-1/2"	Each	6

COVERS FOR ALUMINUM FRY PANS

ITEM	DESCRIPTION	UOM	CASE
ASP-2C	For 8" Fry Pan	Each	12
AXS-16C	For 10" Fry Pan	Each	6
AXS-20C	For 12" Fry Pan	Each	6
AXS-40C	For 14" Fry Pan	Each	6

NSF 3003 SUPER ALUMINUM COOKWARE

Sturdy handles

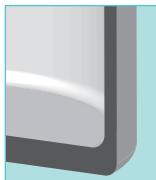

Extra thick reinforced base



AXHB-28



AXHA-60



AXHH-40

SUPER ALUMINUM EXTRA-HEAVYWEIGHT COOKWARE
6.0 MM, 1/4" THICKNESS

- ◆ Extra-durable 6mm thick aluminum core ensures long-lasting performance through constant heating & washing
- ◆ 3003 Aluminum for superior heat distribution
- ◆ Riveted handles designed for strength & durability
- ◆ Wide base & high walls allow for recipe versatility

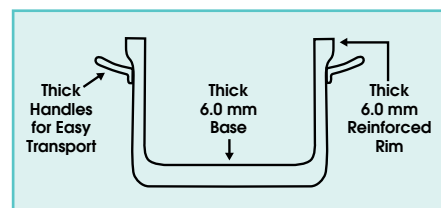
EXTRA HEAVYWEIGHT ALUMINUM STOCK POTS

ITEM	DESCRIPTION	SIZE (DIA X HEIGHT)	UOM	CASE
AXHH-12	12 Qt	10" x 9-1/4"	Each	1
AXHH-16	16 Qt	10" x 12"	Each	1
AXHH-20	20 Qt	12" x 10-1/2"	Each	1
AXHH-24	24 Qt	12" x 12-1/2"	Each	1
AXHH-32	32 Qt	13" x 14"	Each	1
AXHH-40	40 Qt	14" x 15"	Each	1
AXHH-60	60 Qt	16" x 17"	Each	1
AXHH-80	80 Qt	18" x 18-1/4"	Each	1
AXHH-100*	100 Qt	20" x 19"	Each	1
AXHH-120*	120 Qt	20" x 23"	Each	1
AXHH-120H*	120 Qt, 4 Hdls	20" x 23"	Each	1

*Replaces ALHP-Series

COVERS

ITEM	UOM	CASE
AXS-16C	Each	6
AXS-16C	Each	6
AXS-20C	Each	6
AXS-20C	Each	6
AXS-32C	Each	6
AXS-40C	Each	6
AXS-60C	Each	6
AXS-80C	Each	6
AXS-100C	Each	6
AXS-100C	Each	6

EXTRA HEAVYWEIGHT ALUMINUM SAUCE POTS

ITEM	DESCRIPTION	SIZE (DIA X HEIGHT)	UOM	CASE
AXHA-8	8 Qt	10" x 6-1/8"	Each	1
AXHA-14	14 Qt	12" x 7-3/4"	Each	1
AXHA-20	20 Qt	13" x 9-1/4"	Each	1
AXHA-26	26 Qt	14" x 10-1/4"	Each	1
AXHA-34	34 Qt	16" x 10-1/4"	Each	1
AXHA-40	40 Qt	16" x 11-3/4"	Each	1
AXHA-60	60 Qt	18" x 13-3/4"	Each	1

COVERS

ITEM	UOM	CASE
AXS-16C	Each	6
AXS-20C	Each	6
AXS-32C	Each	6
AXS-40C	Each	6
AXS-60C	Each	6
AXS-60C	Each	6
AXS-80C	Each	6

EXTRA HEAVYWEIGHT ALUMINUM BRAZIER

ITEM	DESCRIPTION	SIZE (DIA X HEIGHT)	UOM	CASE
AXHB-15	15 Qt	14" x 5-7/8"	Each	1
AXHB-18	18 Qt	16" x 5-13/32"	Each	1
AXHB-24	24 Qt	18" x 5-5/8"	Each	1
AXHB-28	28 Qt	18" x 6-7/16"	Each	1
AXHB-35	35 Qt	21-3/4" x 6"	Each	1
AXHB-40	40 Qt	22-7/8" x 6"	Each	1

COVERS

ITEM	UOM	CASE
AXS-40C	Each	6
AXS-60C	Each	6
AXS-80C	Each	6
AXS-80C	Each	6
AXS-100C	Each	6
AXS-100C	Each	6



AXS-50



AXAP-20

3003 SUPER ALUMINUM COOKWARE



Sturdy handles

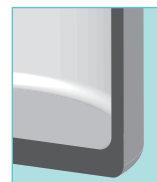

Extra thick reinforced base



AXST-5

SUPER ALUMINUM HEAVYWEIGHT COOKWARE

4.0 MM, 3/16" THICKNESS

- ◆ Durable 4mm thick aluminum core ensures long-lasting performance with constant heating & washing
- ◆ 3003 Aluminum for superior heat distribution
- ◆ Riveted handles designed for strength & durability
- ◆ Wide base & high walls allow for recipe versatility

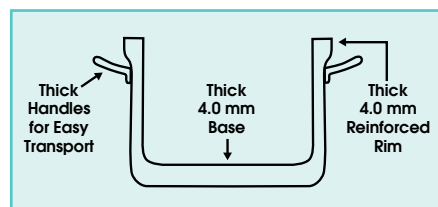

HEAVYWEIGHT ALUMINUM STOCK POTS

ITEM	DESCRIPTION	SIZE (DIA X HEIGHT)	UOM	CASE
AXS-8	8.5 Qt	10" x 6-1/2"	Each	1
AXS-10	10 Qt	10" x 7-1/2"	Each	1
AXS-12	12 Qt	10" x 9"	Each	1
AXS-16	16 Qt	10" x 12"	Each	1
AXS-20	20 Qt	12" x 10-1/2"	Each	1
AXS-24	24 Qt	12" x 12-1/4"	Each	1
AXS-32	32 Qt	13" x 14"	Each	1
AXS-40	40 Qt	14" x 15"	Each	1
AXS-50	50 Qt	16" x 14"	Each	1
AXS-60	60 Qt	16" x 17"	Each	1
AXS-80	80 Qt	18" x 18-1/4"	Each	1
AXS-100	100 Qt	20" x 17-3/4"	Each	1

COVERS

ITEM	UOM	CASE
AXS-16C	Each	6
AXS-16C	Each	6
AXS-16C	Each	6
AXS-16C	Each	6
AXS-20C	Each	6
AXS-20C	Each	6
AXS-32C	Each	6
AXS-40C	Each	6
AXS-60C	Each	6
AXS-60C	Each	6
AXS-80C	Each	6
AXS-100C	Each	6

HEAVYWEIGHT ALUMINUM SAUCE POTS

ITEM	DESCRIPTION	SIZE (DIA X HEIGHT)	UOM	CASE
AXAP-8	8 Qt	10" x 6"	Each	1
AXAP-14	14 Qt	12" x 7-1/2"	Each	1
AXAP-20	20 Qt	13" x 9"	Each	1
AXAP-26	26 Qt	14" x 10"	Each	1
AXAP-34	34 Qt	16" x 10"	Each	1
AXAP-40	40 Qt	16" x 11-1/2"	Each	1

COVERS

ITEM	UOM	CASE
AXS-16C	Each	6
AXS-20C	Each	6
AXS-32C	Each	6
AXS-40C	Each	6
AXS-60C	Each	6
AXS-60C	Each	6

HEAVYWEIGHT ALUMINUM BRAZIER

ITEM	DESCRIPTION	SIZE (DIA X HEIGHT)	UOM	CASE
AXBZ-15	15 Qt	14-3/8" x 5-3/4"	Each	1
AXBZ-18	18 Qt	16-3/8" x 5-1/2"	Each	1
AXBZ-24	24 Qt	18-3/8" x 5-3/4"	Each	1
AXBZ-28	28 Qt	18-3/8" x 6-1/2"	Each	1
AXBZ-35	35 Qt	21-3/4" x 6"	Each	1
AXBZ-40	40 Qt	22-7/8" x 6"	Each	1

COVERS

ITEM	UOM	CASE
AXS-40C	Each	6
AXS-60C	Each	6
AXS-80C	Each	6
AXS-80C	Each	6
AXS-100C	Each	6
AXS-100C	Each	6

HEAVYWEIGHT ALUMINUM SAUTÉ PANS (NON-NSF)

ITEM	DESCRIPTION	SIZE	UOM	CASE
AXST-3	3 Qt	10" x 2-1/2"	Each	6
AXST-5	5 Qt	12-1/2" x 2-1/2"	Each	6
AXST-7	7-1/2 Qt	14-1/2" x 2-3/4"	Each	6

COVERS

ITEM	UOM	CASE
AXS-16C	Each	6
AXS-20C	Each	6
AXS-40C	Each	6

